



up.bike

RAISE YOUR GEAR

UP.BIKE TH-34

HAND DYNOMETER FOR FRONT BIKE SHOCKS OPERATING INSTRUCTIONS

VISIT up.bike/cycling-gear-storage FOR MORE CYCLING GEAR

Finally an affordable hand front shock dyno!

We teamed up with shock tuner and builder Travis Cole at Anvil Bicycle Company to design a dyno with three key objectives: universal, indestructible, and affordable. Finely rebuild and tune your front shocks using a repeatable process check.

The Dyno is universal and will be able to mount most types of fork shocks with the standard mounts provided with The Dyno

The Dyno is constructed using 304 12 gauge stainless and welded for strength by our AWS qualified fabricators to produce a lifetime product.

Up.bike your shop and take tuning to the next level!

WARNING:

**DYNAMETERS ARE UNDER A LARGE AMOUNT OF FORCES ACTING UPON THEM
ENSURE THE DYNOMETER IS PROPERLY SECURED TO A PERMANENT FIXTURE**

DO NOT HANG ON THE DYNOMETER

WEAR PROPER EYE PROTECTION

**PERFORM A VISUAL CHECK ON DYNO HARDWARE AND COMPONENTS BEFORE EACH USE
ALL PINS SHOULD BE FULLY INSERTED, AND COTTER PINS INSERTED WHERE APPLICABLE**

**ALWAYS TAKE THE FIRST STROKE ON ANY SHOCK
SLOWLY WITH 1 HAND
AND VERIFY PROPER ACTION
AND 0 INTERFERENCES**

**DO NOT FULLY COMPRESS STROKE LENGTH OF SHOCKS ON
FULLY CHARGED AIR OR COIL SPRINGS**

**FAILURE TO FOLLOW THESE PROCEDURES COULD RESULT
IN THE SHOCK BECOMING DISMOUNTED
PERSONAL INJURY
OR PROPERTY DAMAGE**

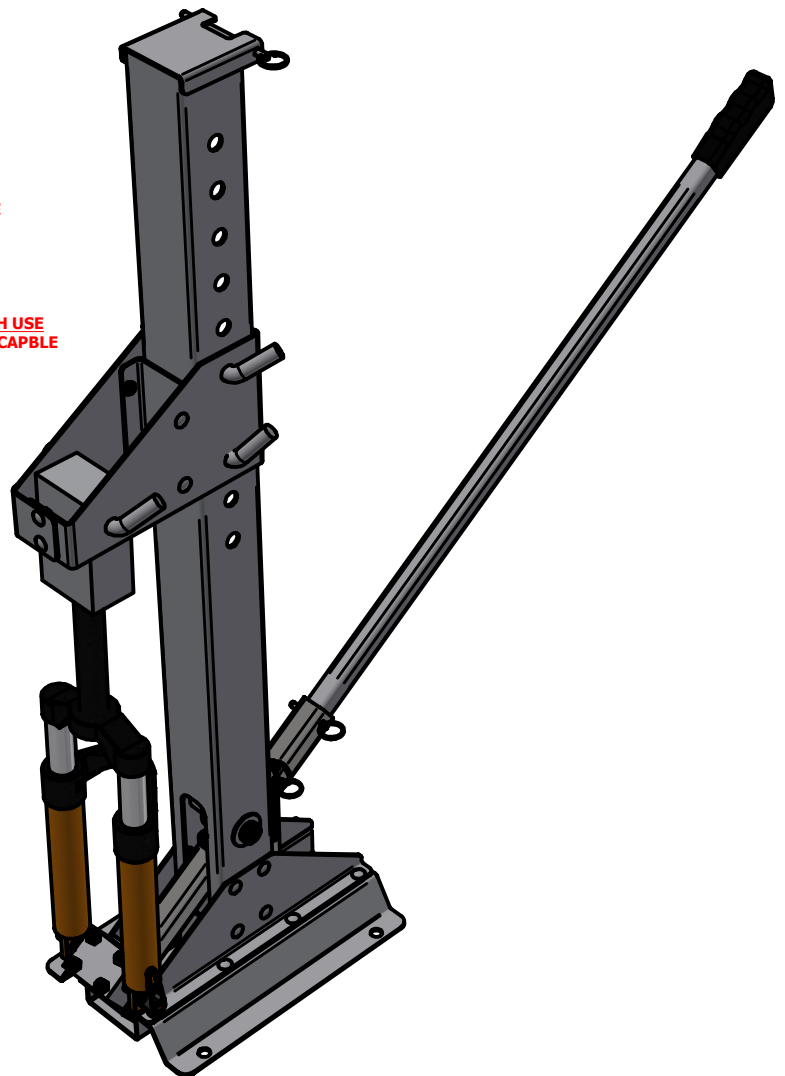

MOUNT TH-34

**FIRST STEP
BEFORE ANY
OPERATION**

**DYNAMOMETER
MUST BE
SECURED TO
A WORK
SURFACE**

FIND THE CORRECT WORK SURFACE, PREFERABLY SOMEWHERE PERMANENT THAT IS SECURED TO THE FLOOR SUCH AS A WORKBENCH

MOUNT DYNO NO MORE THAN 4" FROM THE END OF WORK SURFACE TO ENSURE FULL ARM OPERATION

ATTACH DYNO TO A WORK SURFACE USING 3/8" THRU BOLTS OR LAG BOLTS AT LEAST 1" DEEP

THESE ARE NOT SUPPLIED IN THE KIT, AS IT WILL BE DIFFERENT FOR ALL WORK SURFACES

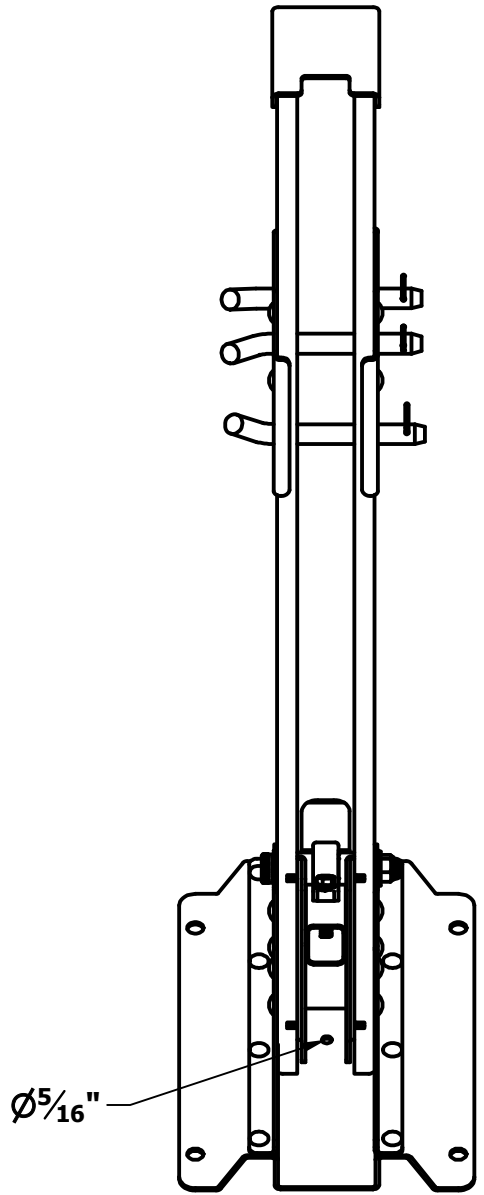
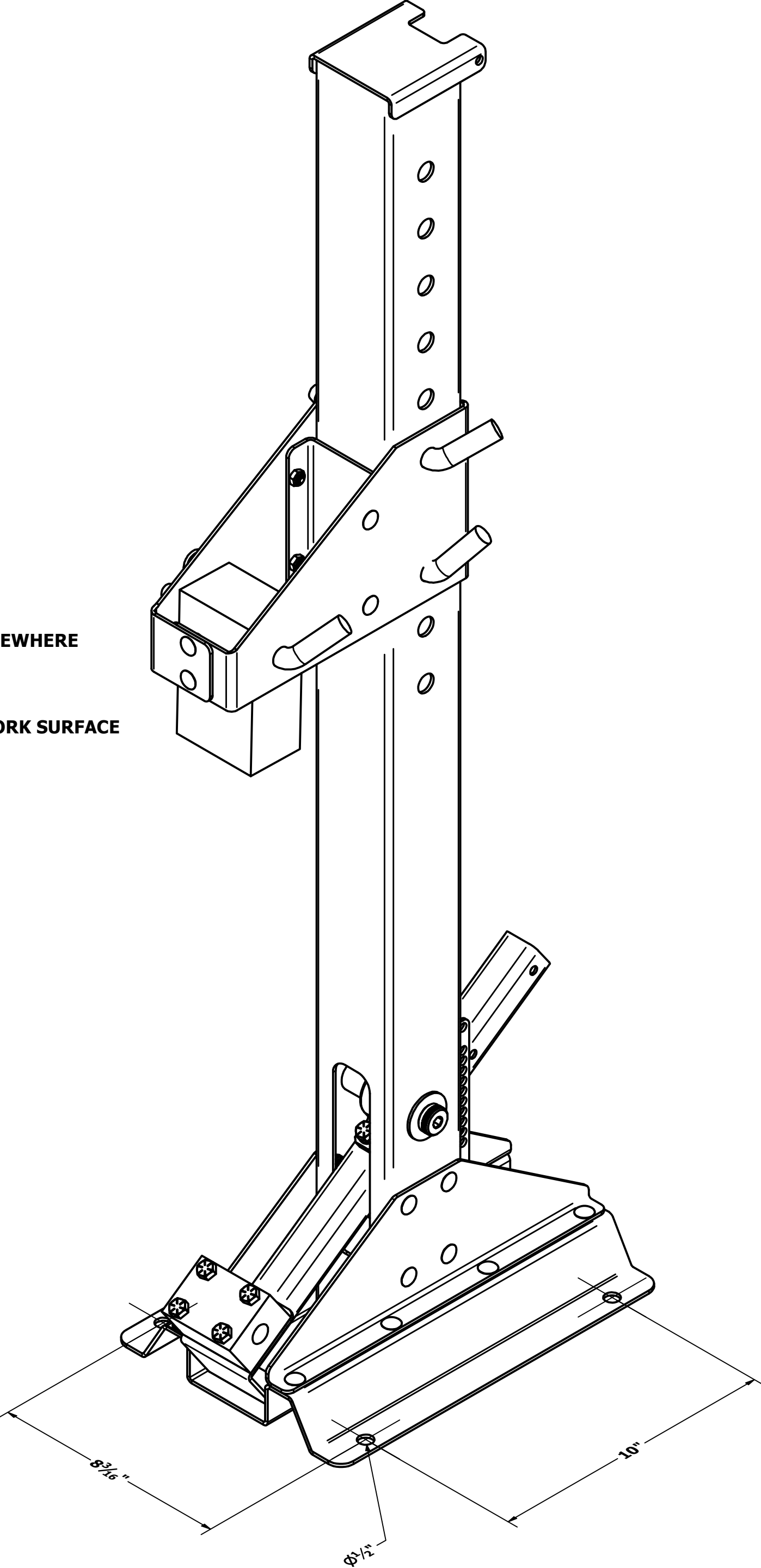

THERE IS A 5TH MOUNTING HOLE ON THE INSIDE OF THE TOWER

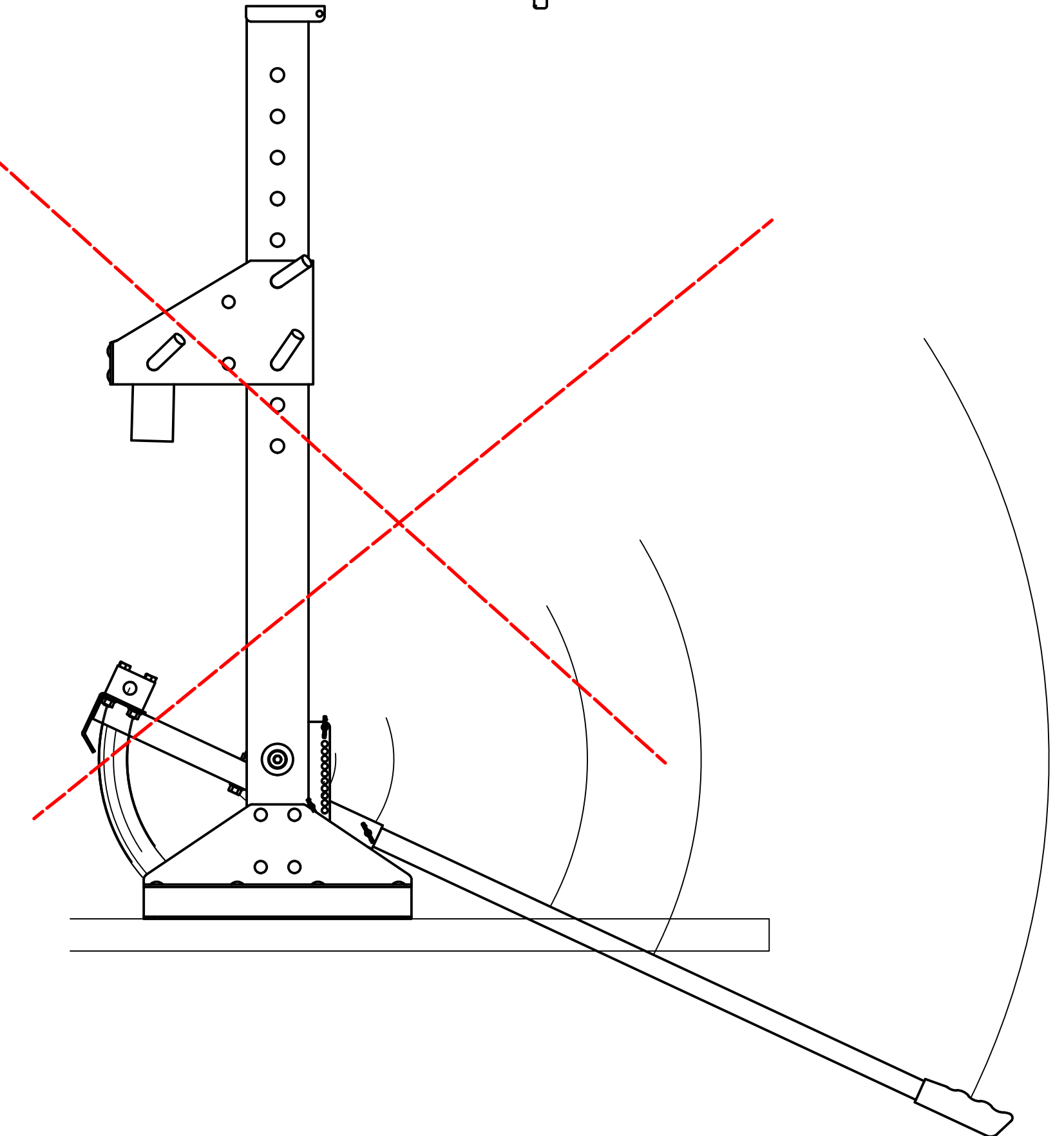
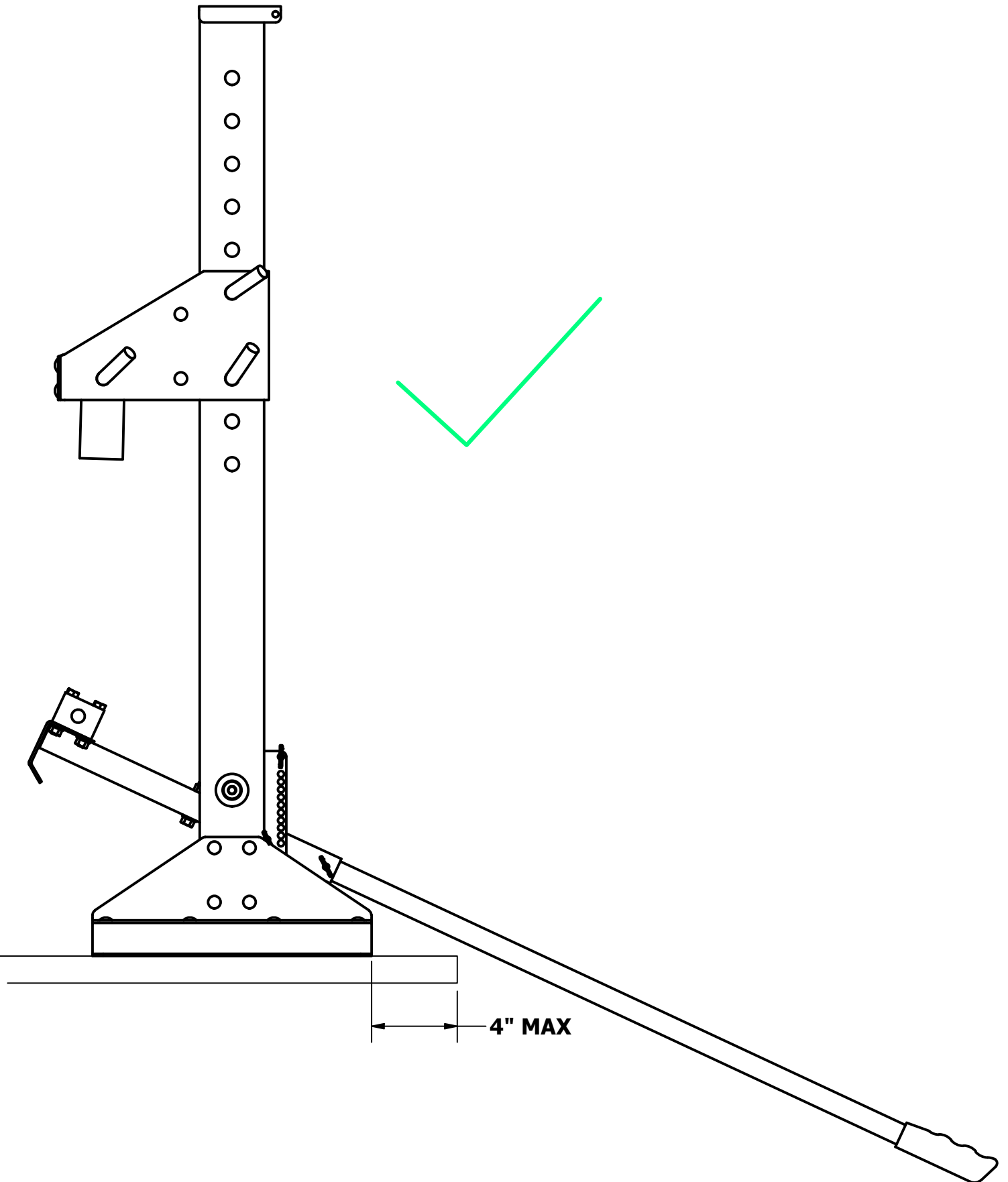
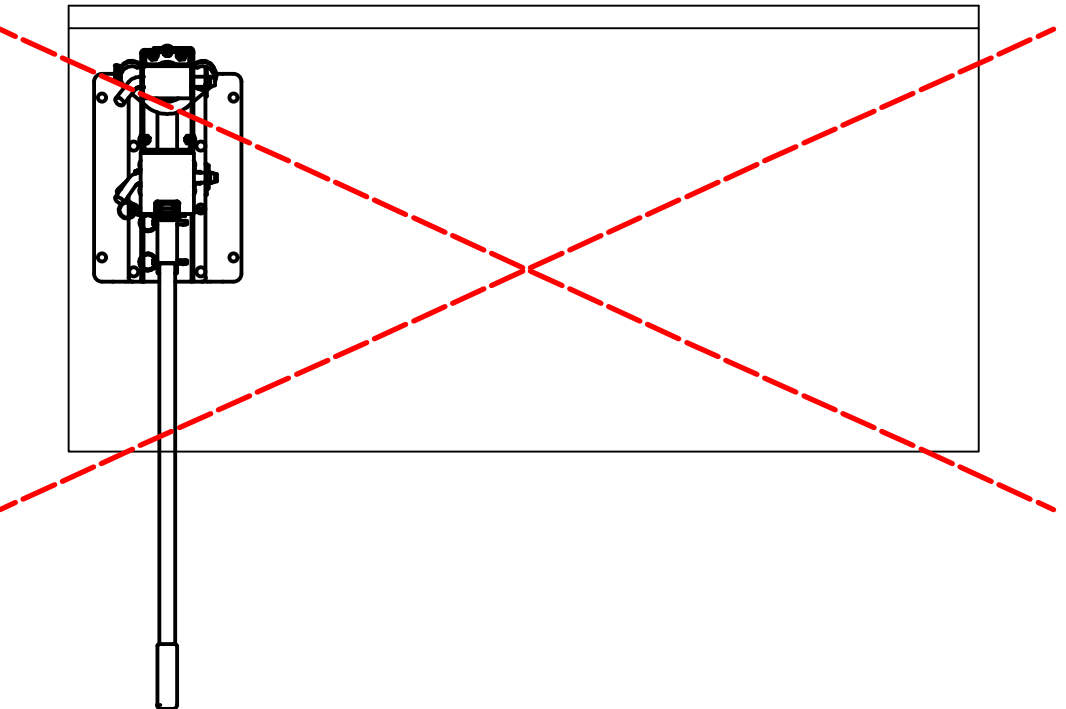
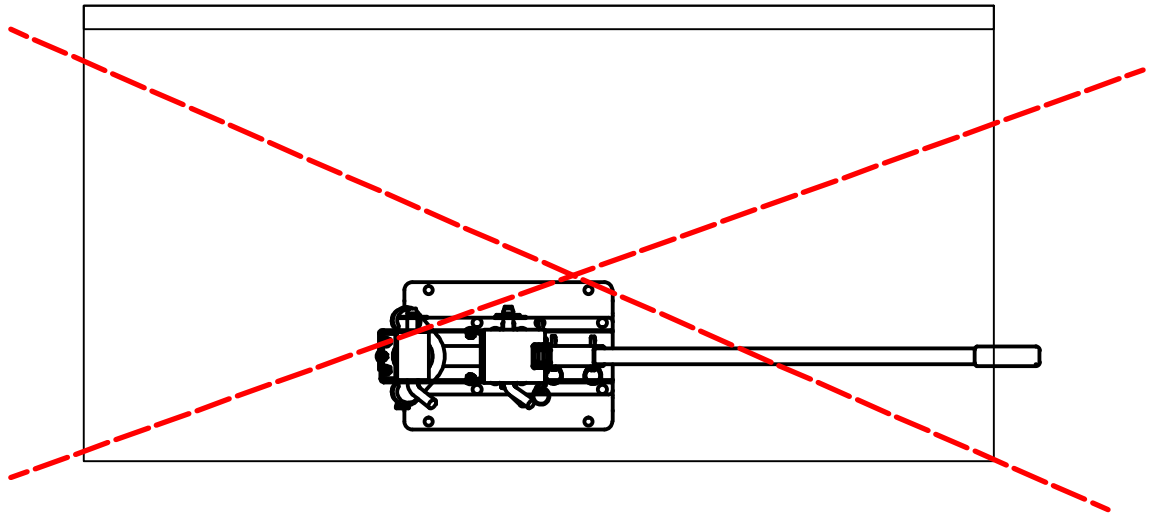
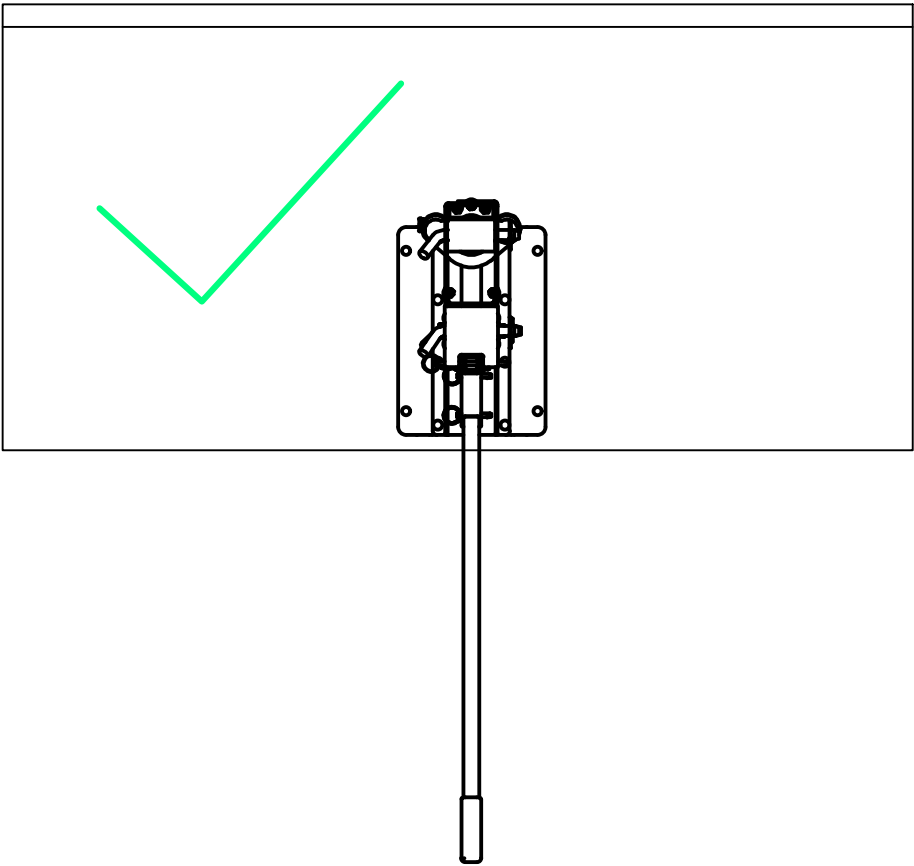
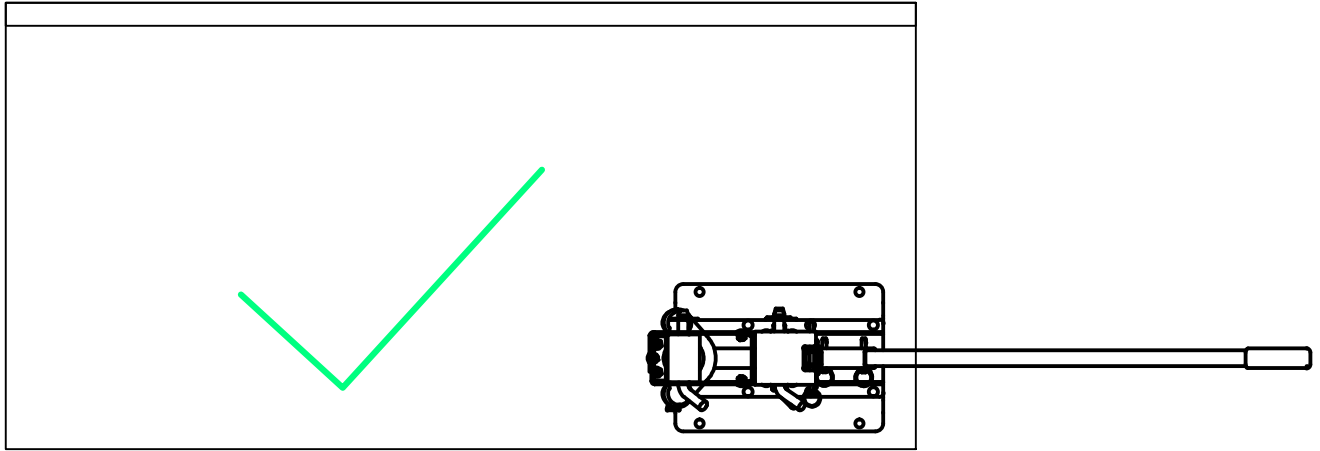

MOUNT SHOCK

DETERMINE THE HEIGHT NEEDED FOR TESTING YOUR SHOCK
ADJUST THE HEIGHT OF THE FORK TUBE MOUNT AS NECESSARY
USING PROVIDED HARDWARE
(2) 5/8" BENT CLEVIS PINS

INSERT THE STEERING TUBE INTO THE HDPE PLASTIC HOUSING

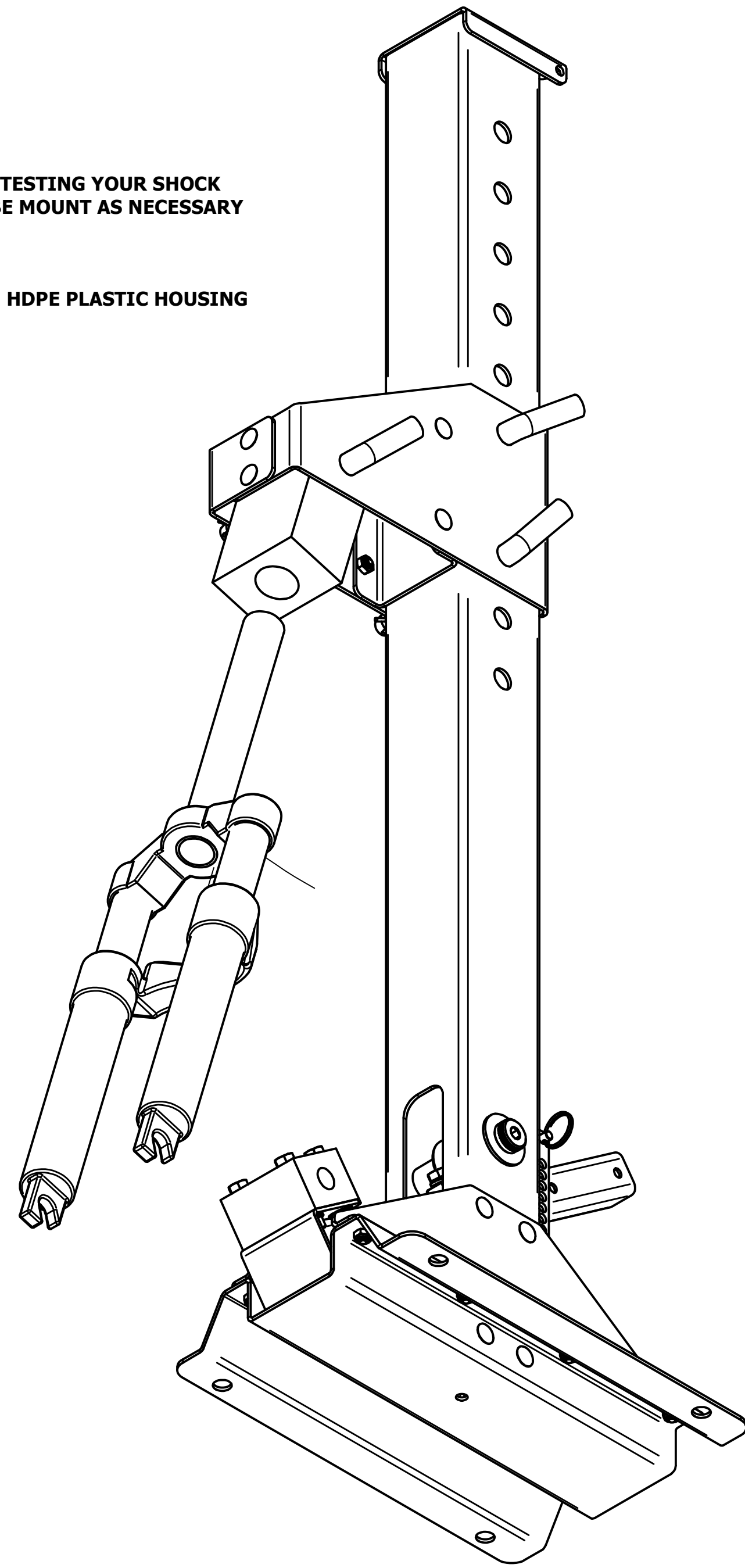

ENSURE STEERING TUBE IS INSERTED FULLY INTO RECIEVER,
MOUNT THE FORK END OF THE SHOCK USING THE SHOCKS AXLE
PASS THE AXLE THROUGH THE BOTTOM HDPE PLASTIC RECEIVER
AND ENSURE THE AXLE IS FULLY INSTALLED

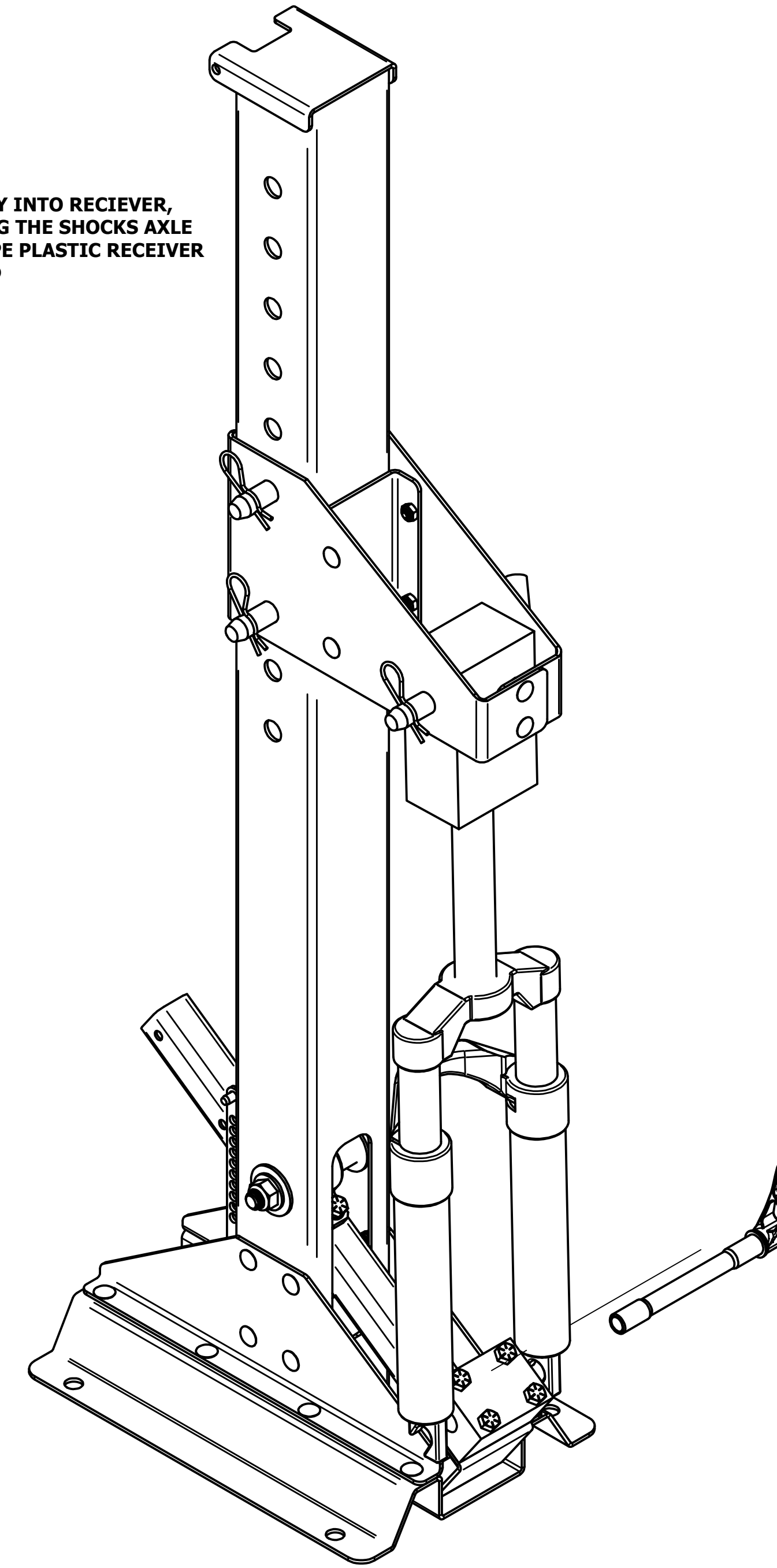

ATTACH ARM

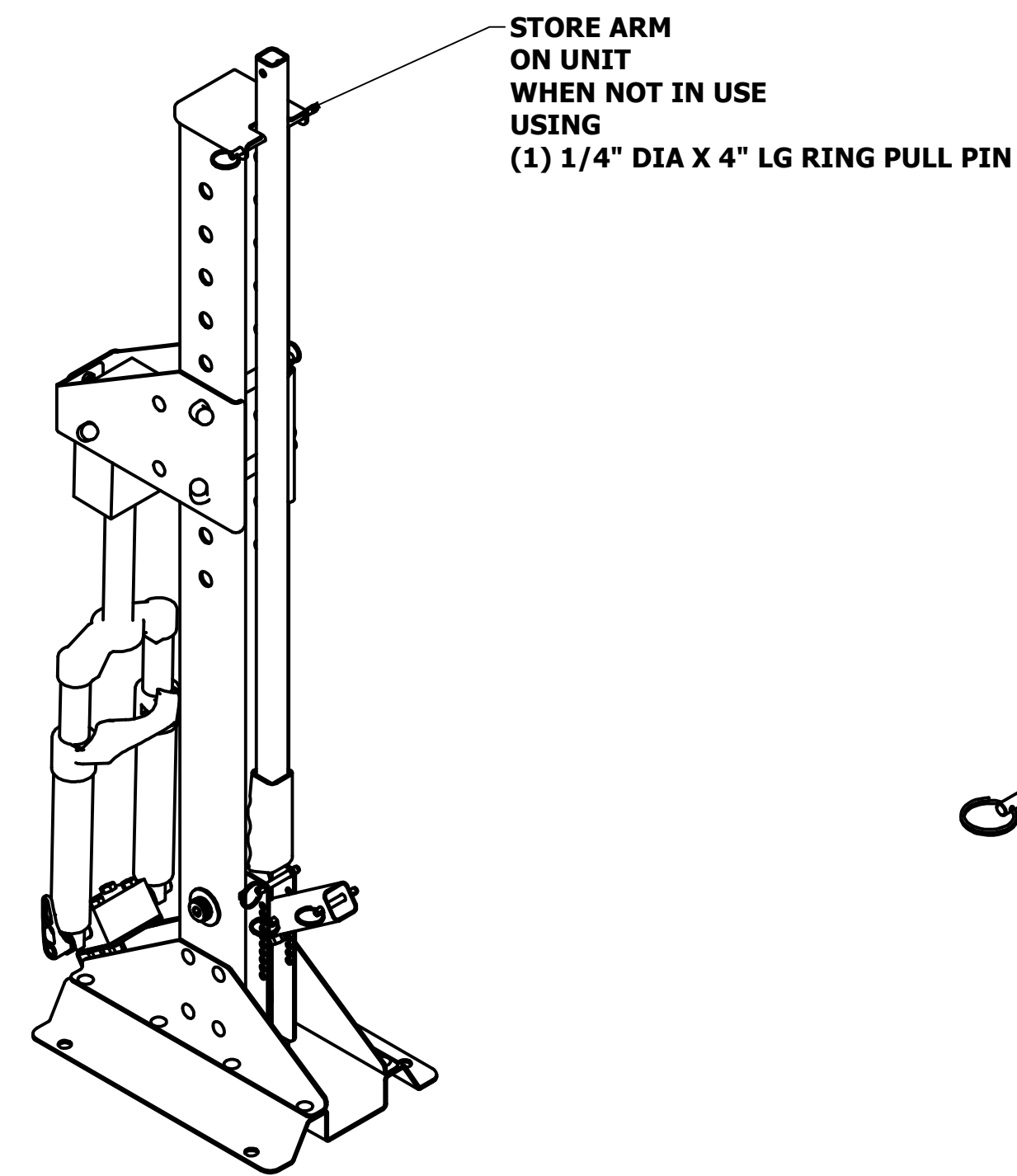

REMOVE ARM FROM STORAGE HANGER

ATTACH ARM ONLY AFTER SHOCK HAS BEEN MOUNTED

INSERT ARM END INTO SLEEVE, WITH THE FINGER AREA OF THE HANDLE FACING UPWARDS AND SECURE USING THE PROVIDED HARDWARE (2) 1/4" DIA RING PULL PINS

ENSURE PINS ARE FULLY INSERTED BEFORE PROCEEDING

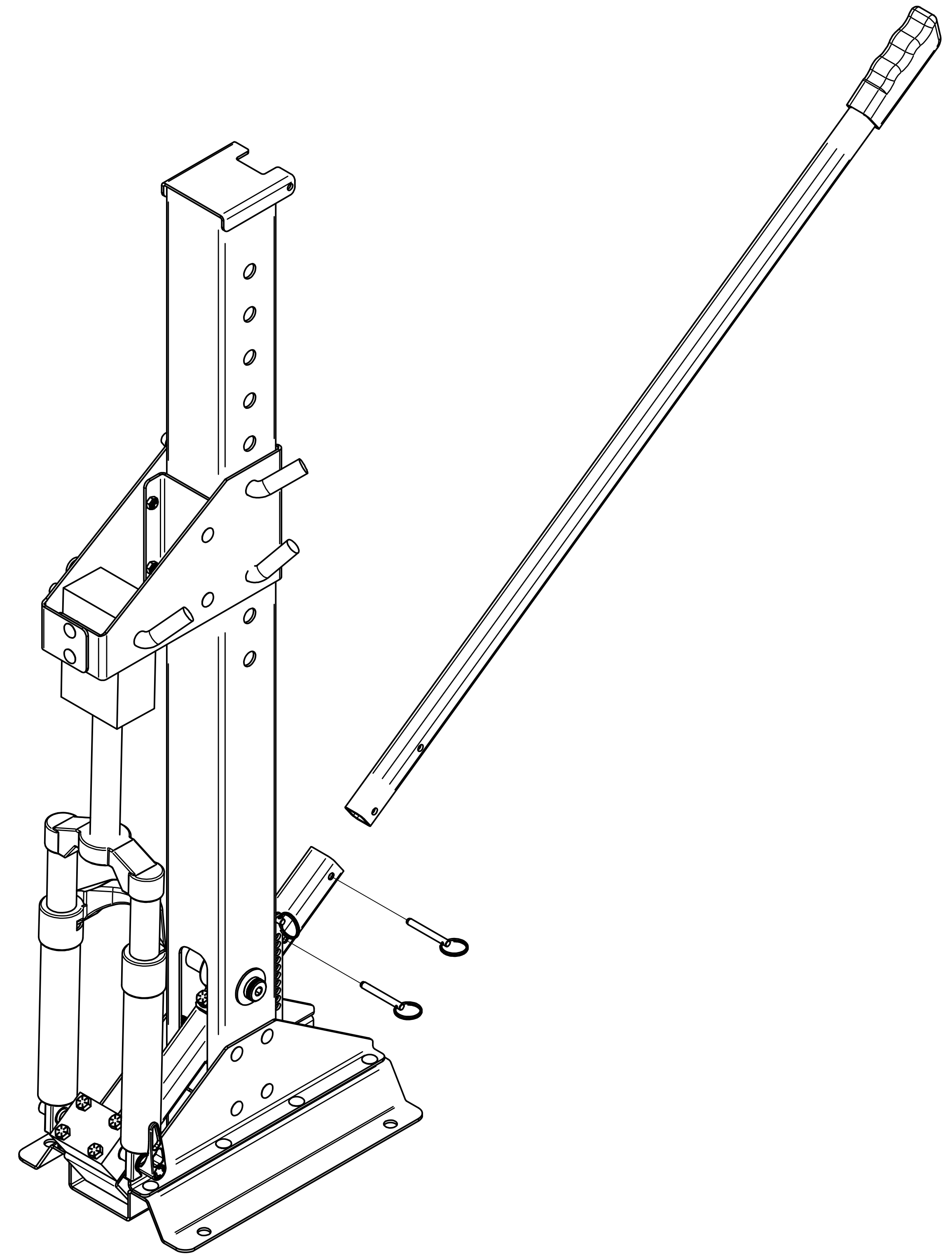
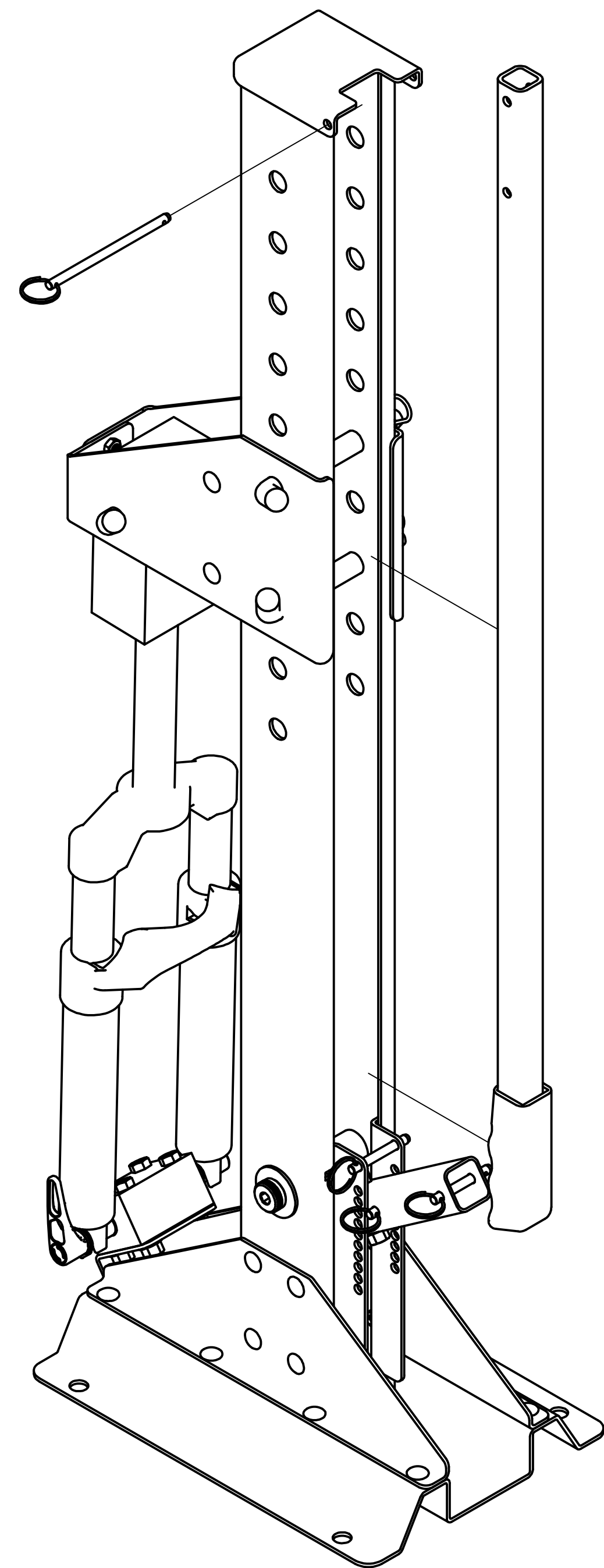

YOU ARE NOW READY TO USE THE DYNOMETER

WARNING:

DYNOMETERS ARE UNDER A LARGE AMOUNT OF FORCES ACTING UPON THEM
ENSURE THE DYNOMETER IS PROPERLY SECURED TO A PERMANENT FIXTURE

DO NOT HANG ON THE DYNOMETER

WEAR PROPER EYE PROTECTION

PERFORM A VISUAL CHECK ON DYNO HARDWARE AND COMPONENTS BEFORE EACH USE
ALL PINS SHOULD BE FULLY INSERTED, AND COTTER PINS INSERTED WHERE APPLICABLE

ALWAYS TAKE THE FIRST STROKE ON ANY SHOCK
SLOWLY WITH 1 HAND
AND VERIFY PROPER ACTION
AND 0 INTERFERENCES

DO NOT FULLY COMPRESS STROKE LENGTH OF SHOCKS ON
FULLY CHARGED AIR OR COIL SPRINGS

FAILURE TO FOLLOW THESE PROCEDURES COULD RESULT
IN THE SHOCK BECOMING DISMOUNTED
PERSONAL INJURY
OR PROPERTY DAMAGE

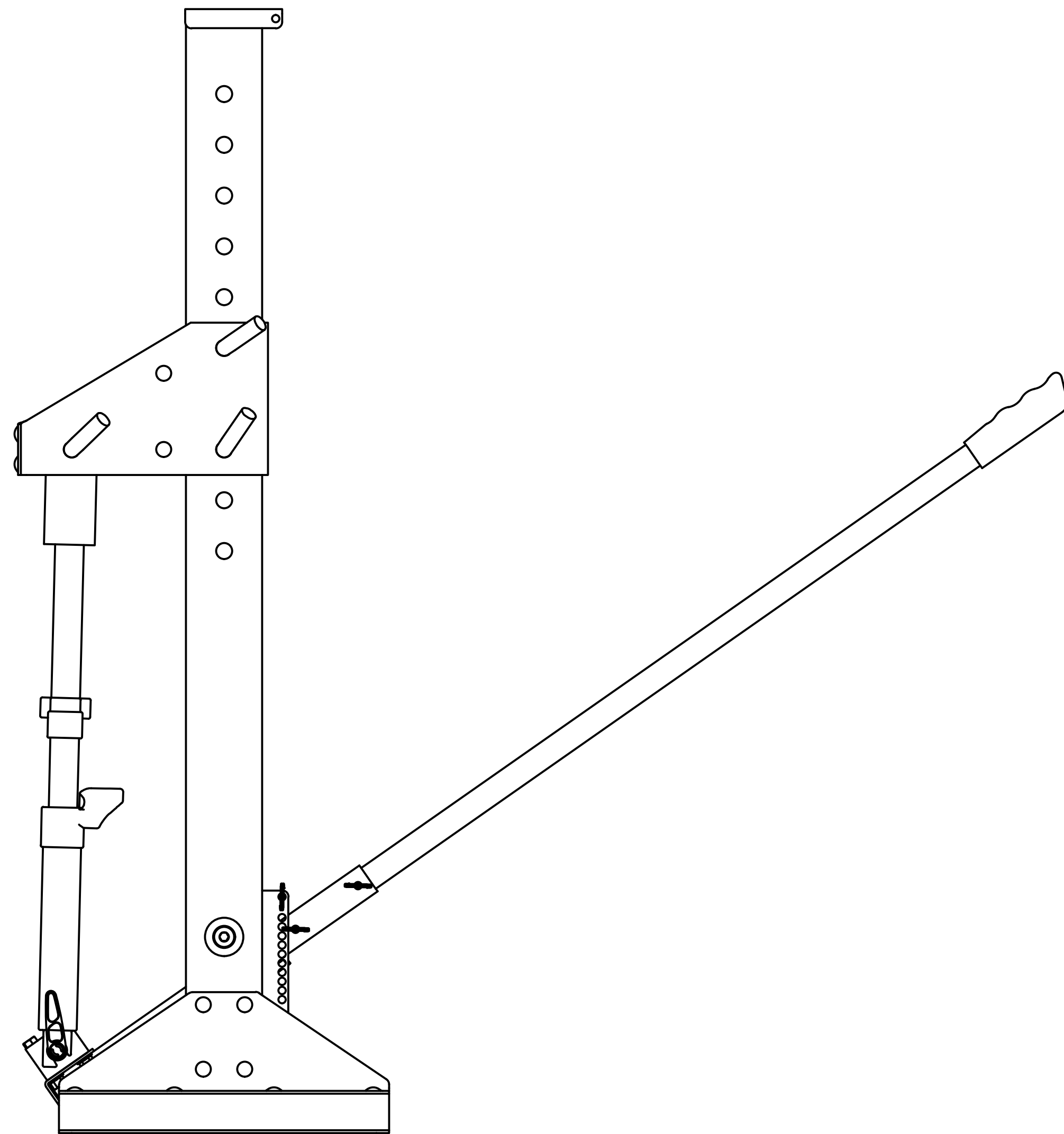

YOU CAN USE THE DYNOMETER FOR LEAK TESTING
BY APPLYING CONSTANT PRESSURE TO THE SHOCK.
COMPRESS THE SHOCK PARTIALLY AND PLACE A 1/4" RING PULL PIN
IN THE KEEPER BRACKET TO HOLD THE ARM DOWN
AND THE SHOCK COMPRESSED

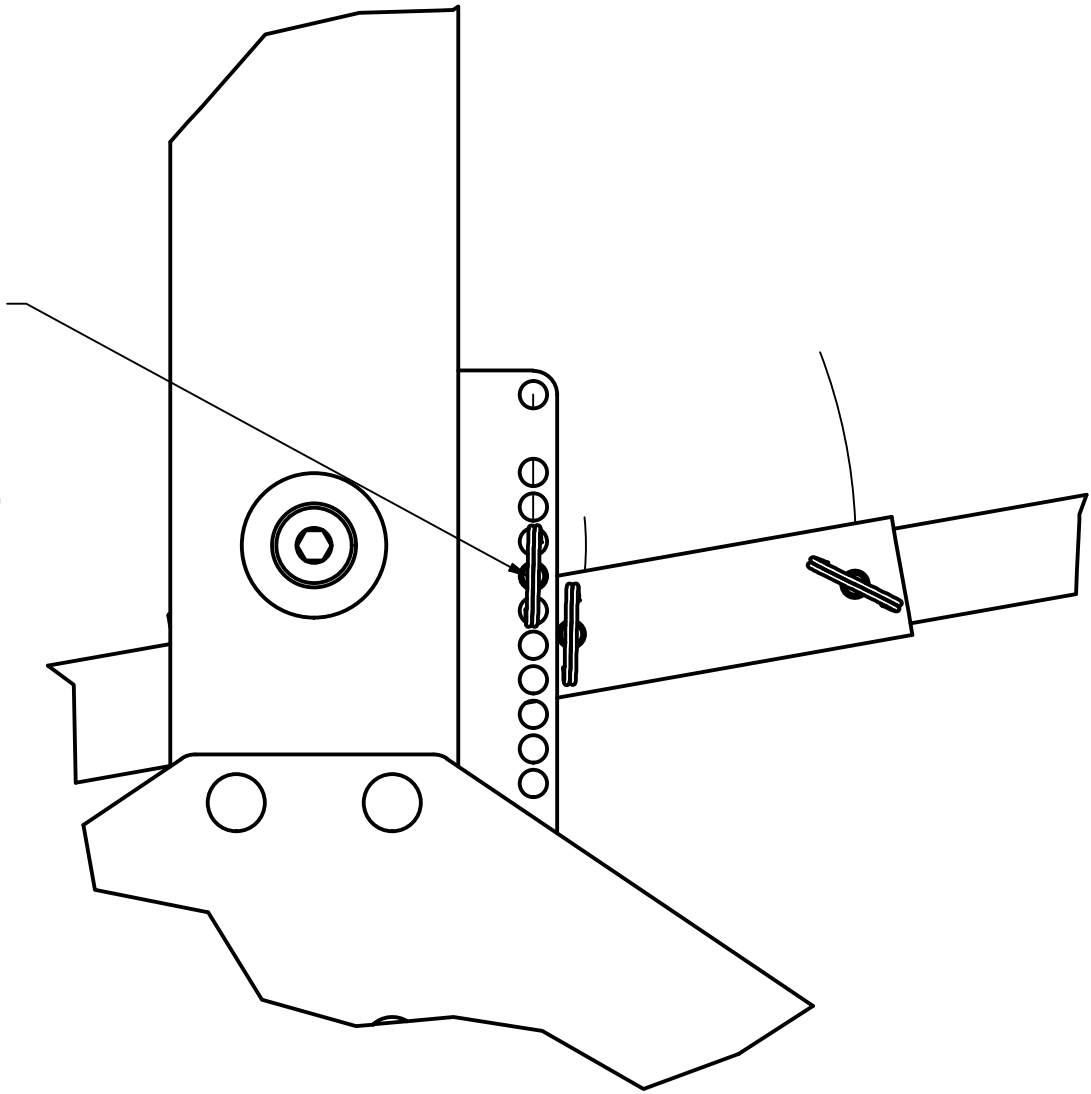

DETAIL C
SCALE 6" = 1'-0"

